

This drawing, as an instrument of service, is the property of Farpoint Architectural Inc. and may not be reproduced without their permission and unless the reproduction carries their name. All designs and other information shown on this drawing are for use on the specified project only and shall not be used otherwise without written permission of the Architects.

Written dimensions shall have precedence over scaled dimensions. Contractors shall verify and be responsible for all dimensions and conditions on the job and the Architects shall be informed of any variations from the dimensions and conditions shown on the drawing. Shop drawings shall be submitted to the Architects for review before proceeding with fabrication.

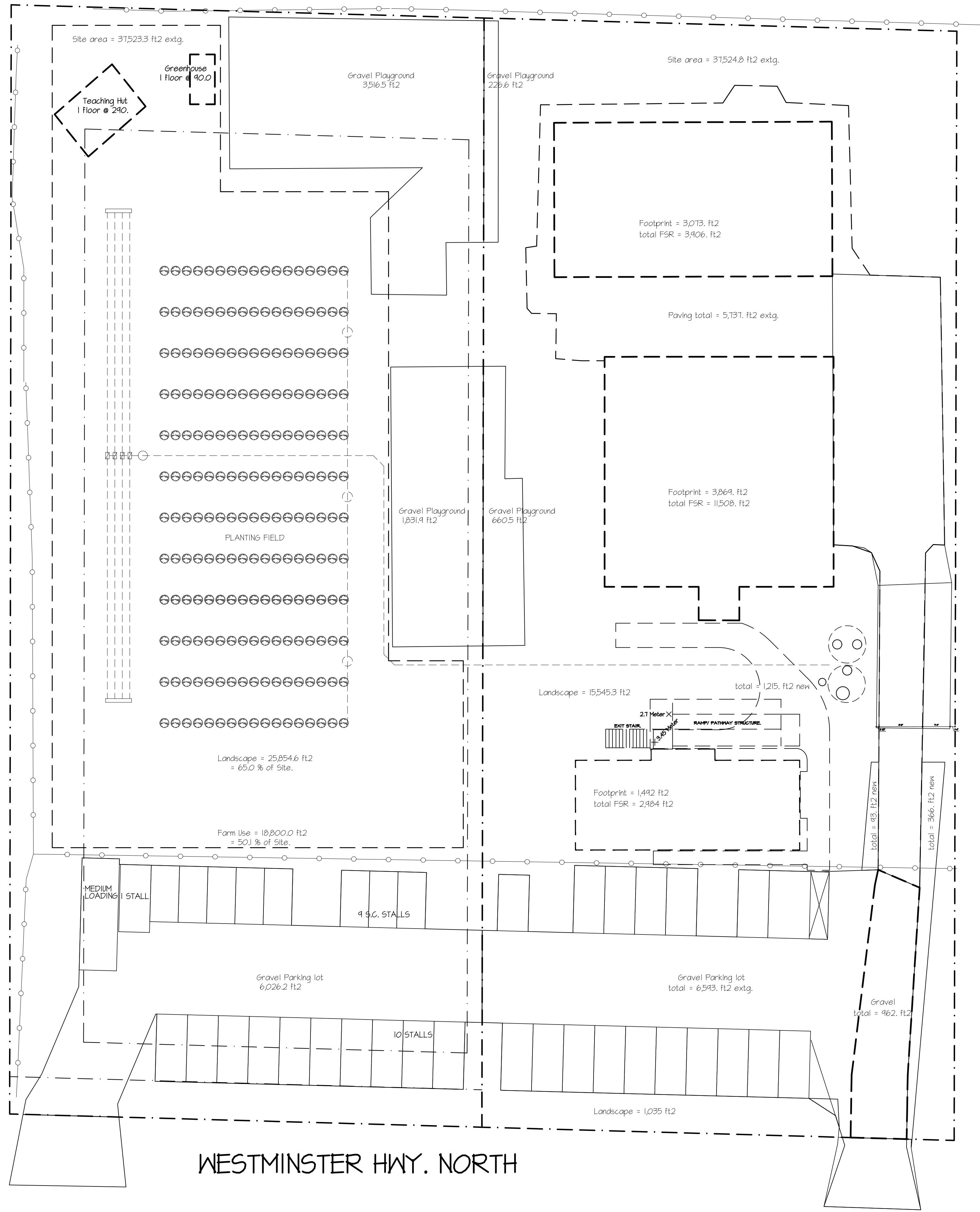

No./Date/Issued		
3	AUG 13 2014	ISSUED FOR CLIENT REVIEW.
4	AUG 21 2014	ISSUED FOR CODE CONSULTANT REVIEW.
6	NOV. 08 2014	ISSUED FOR RICHMOND PLANNING COMMENTS.

13	MAY 13 2020	ISSUED FOR CLIENT REVIEW.
----	-------------	---------------------------

No./Date/Revisions

FARPOINT
Architectural Inc.

1682 West 75th Avenue
Vancouver, Canada
V6P 6G2
Tel 604 734 3826

Seal

Consultant

Project Title

**20451 WESTMINSTER,
20411 WESTMINSTER,
RICHMOND, BC
PROPOSED NEW
PORTABLES.**

Drawing Title

**PRELIMINARY
SITE
STATISTICS.**

Date JULY 10/19

Scale 1/16" = 1'-0"

Drawn JK

Approved JK

Project Number 19147-CS

Drawing Number